

**BATTERY INFORMATION & WARNING**

Before replacing batteries, read the enclosed BATTERY INFORMATION/ WARNING insert in your original packaging. For additional battery safety, handling, and product information, visit www.surefire.com/batteries.

MAINTENANCE

Use a clean, dry cloth to wipe off body and window. Periodically clean and lubricate threads.

ACCESSORIES

SureFire offers accessories for most of its illumination tools. For a complete listing, visit www.surefire.com/partsaccessories.

THE SUREFIRE NO-HASSLE GUARANTEE

We'll do what it takes to keep your SureFire gear running smoothly. SureFire warrants that if you — our customer — purchase one of our products, and we determine that it is defective in material and/or workmanship during your lifetime, we will repair or replace it — no hassle!

Our warranty does not cover consumables or normal wear-and-tear — things like battery draining, headbands and headpads wearing out, ink cartridges running out, and switches wearing out — or damage resulting from abuse, alterations, unauthorized repairs, or use contrary to SureFire's user manuals.

Should you need a replacement product, SureFire reserves the right to replace an obsolete product with a current production, like model. In the event that any issue with a SureFire product is not covered under this warranty SureFire can arrange to have the product repaired for a reasonable fee.

STANDARD DISCLAIMER

Except as specified above or prohibited by applicable law: all express or implied conditions and warranties, including, without limitation, any implied warranty or condition of merchantability or fitness for a particular purpose, or accuracy of any informational content, are hereby excluded and disclaimed by SureFire; and in no event will SureFire be liable for any special, direct, indirect, consequential, incidental or punitive damages howsoever arising and regardless of the theory of liability, even if advised of the possibility of such damages. Products, prices, availability, specifications, and offers are subject to change or cancellation at any time without notice.

WARRANTY CLAIMS

For claims, contact Customer Service at 714-545-9444 to obtain a Return Merchandise Authorization number (RMA#). Then package the unit carefully and send to (no CODs):

SureFire, LLC.
Repairs Department, RMA# _____
17680 Newhope Street, Suite B
Fountain Valley, CA 92708

SureFire will pay any reasonable shipping costs to return the unit to you.

Revision A 1-2025
71-01-1166
XC3-A



XC3

COMPACT HANDGUN LIGHT

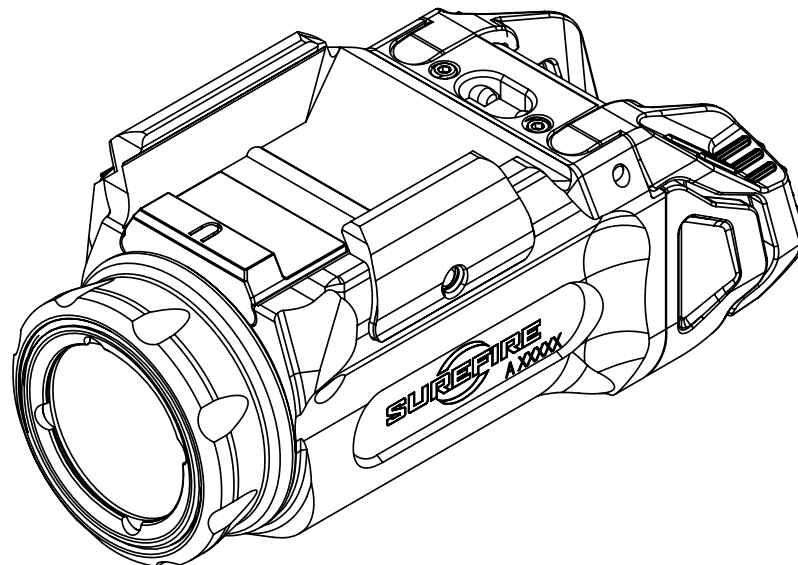

SPECIFICATIONS	XC3-A	
	OUTPUT	550 lumens
	RUNTIME	1.75 hours
	PEAK BEAM INTENSITY	7,200 candela
	DISTANCE	170 meters
	CONSTRUCTION	Aluminum
	FINISH	Hard Anodized (MIL-A-8625 Type III, Class 2)
	WEIGHT (w/battery)	2.65 oz (75 g)
	LENGTH	2.6 in (6.6cm)
	BEZEL DIAMETER	.945 in (2.4 cm)
	BATTERY	One 123A lithium (incl.)
	SWITCHING	Ambidextrous push/toggle

All performance claims tested to ANSI/PLATO FL1-2019 Standard.

BEFORE INITIAL USE, REMOVE BATTERY INSULATOR

KIT CONTENTS

- XC3 WeaponLight
- One 123A Battery
- Picatinny Crossmember
- Universal Crossmember

BATTERY INSTALLATION / REPLACEMENT

⚠ WARNING

Use of substandard batteries can cause injury or property damage. Visit www.surefire.com/batterysafety.

1. Insert 123A battery with terminals oriented as shown in the engraved schematic on XC3 body (Figure 1).
2. Install light head by lining up the mark on the head with the unlock symbol on the body. Push the head toward the body and then rotate the head to either the disable position, for light storage, or the locked position, for use (Figure 2).

CAUTION: Always use a fresh battery when replacing old ones.

MOUNTING XC3 TO WEAPON

⚠ WARNING

ALWAYS confirm weapon is unloaded and on SAFE before attempting installation.

The XC3 ships with multiple crossmembers to fit a range of firearm rails. The Universal (marked "U") crossmember comes pre-installed. To attach the XC3 to a Universal accessory rail, skip ahead to ATTACHING TO HOST WEAPON RAIL instructions. To attach the XC3 to a different rail, the Universal crossmember must be replaced with the included appropriate crossmember. Proceed to INSTALLING / REPLACING THE CROSSMEMBER.

INSTALLING / REPLACING THE CROSSMEMBER

1. Remove the light from the firearm.
2. Rotate the head counterclockwise to unlocked position and pull to remove from body.
3. Slide crossmember out of cutouts to remove it from body (Figure 3).
4. Insert appropriate crossmember for host firearm.
5. Align indicator mark on head with unlock symbol on body.
6. Reattach head and rotate it to desired (locked or disabled) position.

ATTACHING TO HOST WEAPON RAIL

Note: The appropriate Crossmember MUST be installed ("U" for Universal rails; "P" for Picatinny rails) to attach XC3 to a weapon's accessory rail. Some pistols with a MIL-STD-1913 rail may require the "U" crossmember to properly interface with the location of the front trigger guard surface. You may rotate the crossmembers for more fitment options.

1. Adjust gap between fixed and movable rail by turning rail-adjustment bolt (Figure 4) clockwise or counterclockwise until gap is sufficiently wide to fit over weapon accessory rail (Figure 5).
2. Align fixed rail with weapon's accessory rail and hinge XC3 over the cross slot of host weapon.
3. Mate crossmember with corresponding slot in weapon's accessory rail.
4. Using a torque wrench and a flathead bit, tighten to 8 in-lb onto a polymer pistol rail and to 8-9 in-lb on a metal pistol rail. If a torque wrench is not available, tighten until snug and then apply an additional 1/4 turn. **DO NOT OVERTIGHTEN!** The rail-adjustment bolt will break if excessive force is applied with a tool.

LIGHT OPERATION

For momentary-on light operation, press and hold either the right or left side of tailcap toggle switch; release to turn light off (Figure 6).

For constant-on operation, activate by a quick tap and release action via either toggle switch (Figure 6).

FIGURE 1

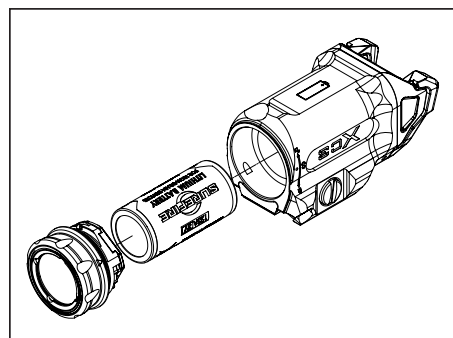

FIGURE 2

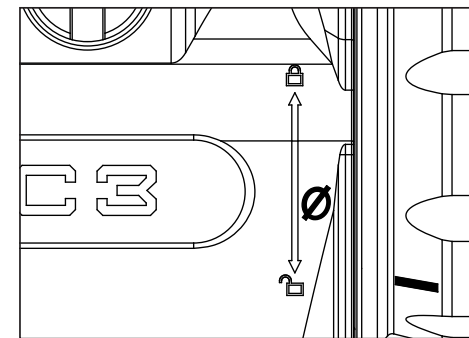

FIGURE 3

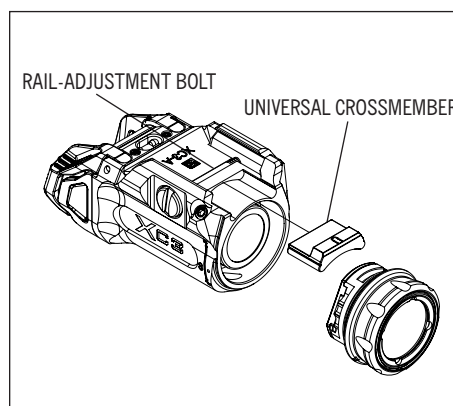

FIGURE 4

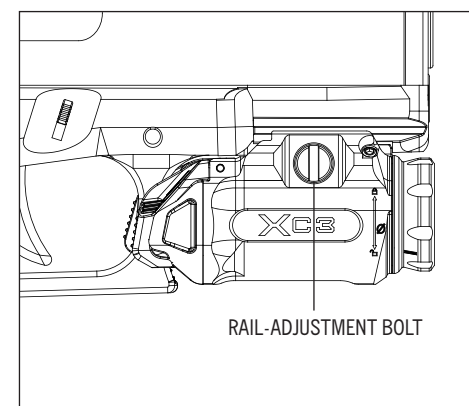

FIGURE 5

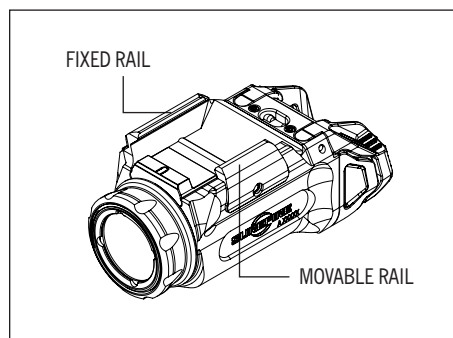

FIGURE 6

