

## Angel Eyes E3 Series Hybrid Keychain Flashlight User Manual

**\*4-click to unlock before the first use.**

### Features

1. Made of 6063 aluminum alloy (E3) or 7075 aluminum alloy (E3 Pro)
2. Dual-power, built-in Li-po and replaceable AAA battery.
3. Rotatable head replacing the AAA battery (Patented)
4. Automatically switch battery when it's low or AAA battery installed
5. Continuously light output when replacing the AAA battery
6. USB-C rechargeable (charge the Li-po battery only)
7. Reversible pocket clip
8. IPX7 waterproof

Size: 66.1mm/2.6" (L)\*27.5mm/1.08" (W)\*13.5mm/0.53" (H)

Weight: 32g/1.13oz

Accessories: User manual, key ring (1 of each L & S size), Pocket clip, warranty card

### Operation

#### 1) Battery check: Every first action of the turn-on

Blue: internal Li-po battery

Green: external AAA battery

#### 2) Battery switch (manually)

**At the moonlight mode, rapid triple click or above**

2.1 Switch successfully

From Li-po to AAA: the Green indicator will come on for 3 seconds

From AAA to Li-po: the Blue indicator will come on for 3 seconds

2.2 Switch failed

From Li-po to AAA: the Blue indicator will flash for 3 seconds

From AAA to Li-po: the Green indicator will flash for 3 seconds

#### 3) Automatically switch battery

3.1 AAA battery installed, it will use that battery for power supply.

3.2 One of the battery is low (Lipo <3.0V, AAA <0.8V), it will switch to the other battery to work.

#### 4) Lockout/Unlock: From off, rapid quad click;

When locked, the Blue indicator (Lipo) will flash 3 seconds after any action applied,

When unlocked, the Green indicator (AAA) will flash 2 seconds.

#### A. 6500K cool white, or 4000K warm white, 95 CRI

1. From off, click >> moonlight, click again >> turn off
2. From off, press and hold >> momentary on (High), release >> turn off
3. From off, rapid double click >> turn on from the memorized mode, click >> cycle through low-med-high, press 0.5s >> turn off, the turn off will memorize the last-used mode.
4. From off or turned on by rapid double click, rapid triple click >> turn on the strobe mode, click or press 0.5s >> turn off

#### B. Cool white + Warm white

1. From off, click >> turn on the moonlight of the memorized light source, click >> cycle through cool white – warm white, press 0.5s >> turn off, the turn off will memorize the last-used light source.
2. From off, press 0.5s >> turn on the 2 LEDs together from the memorized mode, click >> cycle through low-med-high, press 0.5s >> turn off, the turn off will memorize the last-used mode.
3. From off or the 2 LEDs together turned on, rapid double click >> turn on the memorized mode of the memorized light source, rapid double click >> switch between cool white – warm white, click >> cycle through low-med-high, press 0.5s >> turn off, the turn off will memorize the last-used mode of the last-used light source.
5. From off, or the 2 LEDs together turned on, or turned on by rapid double click, rapid triple click >> turn on the strobe mode, click or press 0.5s >> turn off



### C. Cool white + Red

1. From off, click >> turn on the moonlight of the memorized light source, click >> cycle through cool white – red, press 0.5s >> turn off, the turn off will memorize the last-used light source.
2. From off, press 0.5s >> turn on the memorized mode of the warm white, click >> cycle through low-med-high, press 0.5s >> turn off, the turn off will memorize the last-used mode.
3. From off, rapid double click >> turn on the red from low mode,
  - 3.1 click >> cycle through low-high
  - 3.2 rapid double click >> cycle through between white-red
  - 3.3 press 0.5s >> turn off
4. From off, the warm white turned on, or red turned on, rapid triple click >> turn on the red flash mode from the memorized mode, click >> cycle through beacon – flash, press 0.5s >> turn off, the turn off will memorize the last-used mode.

### How to replace AAA battery

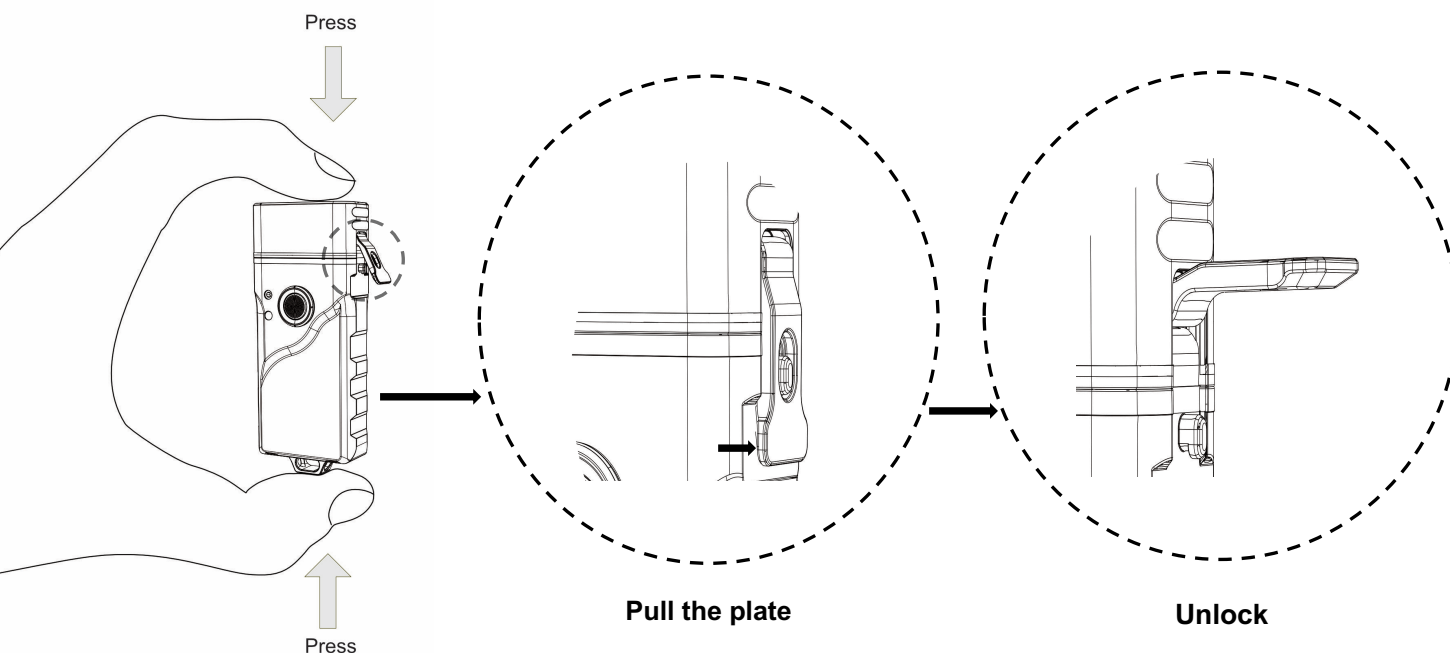

### USB-C Charge & Charge Indicator

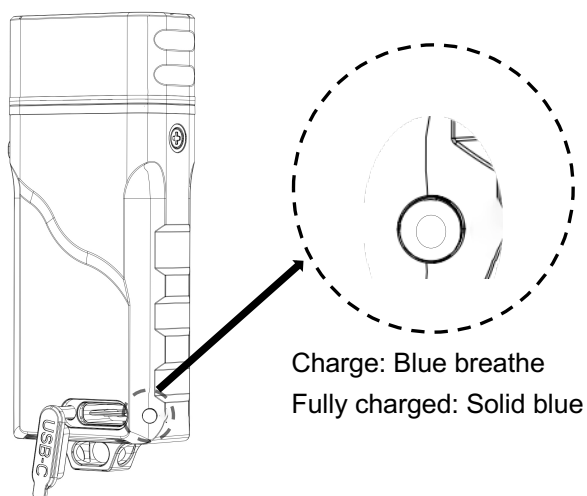

### Reversible Pocket clip

